

一体化直驱模组  
All-in-one direct-drive module

# RMD-H-系列

RMD-h-Direct Drive Series系列

驱动集成 / 高精度度 / 大空洞 / 高速

Drive integration / high precision / large hollow / high speed



懂你的心 更懂如何用心

Understand what you need in heart and  
know how to make effort diligently

11

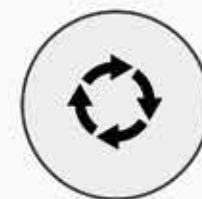

低速稳

STABLE AT LOW SPEED



低噪音

LOW NOISE



高精度

HIGH PRECISION

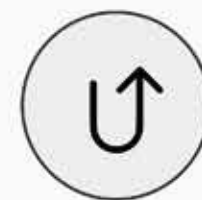

承载力强

STRONG CARRYING CAPACITY

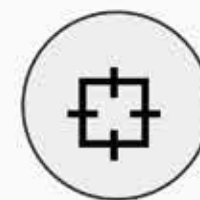

精准控制

PRECISE CONTROL



便捷操作

EASY TO OPERATE

RMD-H系列产品命名规则  
RMD-L SERIES NAMING CONVENTIONS

H SERIES DIVERSIFIED APPLICABLE SCENARIOS

H系列多元化适用场景



人形机器人  
Humanoid robots



机械臂  
Robotic arm



外骨骼机器人  
Exoskeleton robots



四足机器人  
Quadruped robots



AGV智能搬运车  
AGV smart truck



ARU 机器人技术  
ARU Robotics

RMD-H-50-10-C

① ② ③ ④ ⑤

- ① 品牌名称: RMD (Reducer Motor Drive)  
Brand Name R-Reducer M-Motor D-Drive
- ② H代表中空系列  
H Stands For The Hollow series
- ③ 50代表基座号 例如: 50 90等  
50 Represent Motor Model Number e.g: 50 90 etc
- ④ 中空轴内径 10  
Hollow Shaft Inner Diameter 10
- ⑤ 通信方式 C: CAN bus R: RS485 E: Ethercat  
Communication C: CAN bus R: RS485 E: Ethercat

例如 For example

型号 RMD-H-90-10-C

说明 RMD: 品牌名  
H: 中空系列  
90: 基座号  
10: 中空轴内径  
C: CAN bus 通信

Model RMD-H-90-10-C

Illustrate RMD: Brand Name  
H: Output shaft series  
90: Represent Motor Model Number  
10: Hollow Shaft Inner Diameter  
C: Communication C: CAN bus

系列名 Series Name

RMD-H

电机简称 Motor Simplified Name

H-50



单编码器 Single Encoder

型号 Actuator Full Name	通信方式 Communication
RMD-H-50-12-C	CAN

尺寸安装图 Installation Drawing

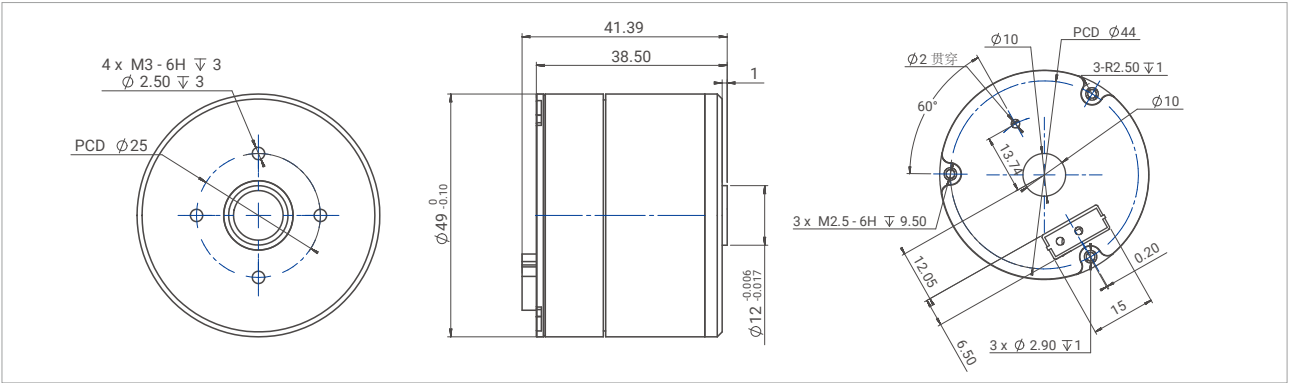

产品参数 Product Parameters

产品名称 Item Name		H-50
额定电压 Nominal Voltage	V	24
额定电流 Nominal Current	A	0.8
最高瞬时电流 Highest instantaneous current	A	4(≤10s)
额定功率 Rated power	W	19.2
通信方式 Communication	-	CAN
额定扭矩 Nominal Torque	N.M	0.3
最高瞬时扭矩 Highest instantaneous torque	N.M	0.9(≤10s)
有效转速区间 Effective speed range	-	10-300
最高重复定位精度 Highest repeatability	-	0.1
最大转速 Maximum rotational speed	RPM	600
相电阻 Phase resistance	Ω	1.83
相间电感 Phase to Phase Inductance	uH	201
电机重量 Motor weight	kg	0.19

系列名 Series Name

RMD-H

电机简称 Motor Simplified Name

H-90



单编码器 Single Encoder

型号 Actuator Full Name	通信方式 Communication
RMD-H-90-22-C	CAN

尺寸安装图 Installation Drawing

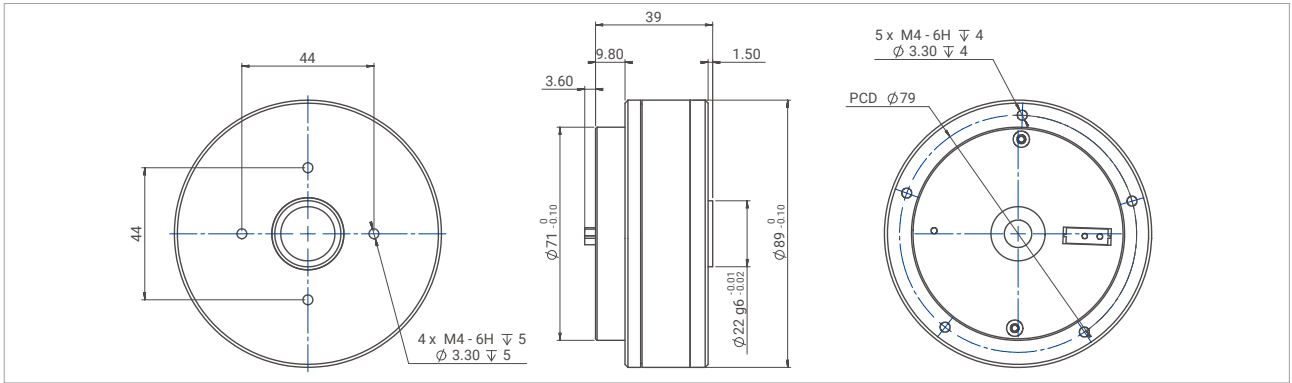

产品参数 Product Parameters

产品名称 Item Name		H-90
额定电压 Nominal Voltage	V	24
额定电流 Nominal Current	A	1.8
最高瞬时电流 Highest instantaneous current	A	9(≤10s)
额定功率 Rated power	W	43.2
通信方式 Communication	-	CAN
额定扭矩 Nominal Torque	N.M	0.8
最高瞬时扭矩 Highest instantaneous torque	N.M	2.4(≤10s)
有效转速区间 Effective speed range	-	10-300
最高重复定位精度 Highest repeatability	-	0.1
最大转速 Maximum rotational speed	RPM	500
相电阻 Phase resistance	Ω	1.06
相间电感 Phase to Phase Inductance	uH	770
电机重量 Motor weight	kg	0.48