

一体化谐波模组
Integrated Harmonic Module

RH中空-系列

RH -Harmonic-Series

一体化设计、耐振动
Integrated Design、Vibration Resistance



懂你的心 更懂如何用心

Understand what you need in heart and
know how to make effort diligently

||

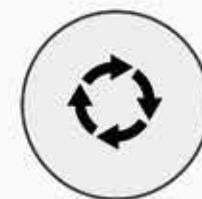

低速稳
STABLE AT LOW SPEED



低噪音
LOW NOISE



高精度
HIGH PRECISION

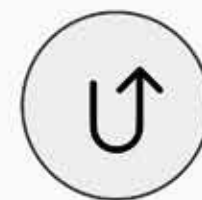

承载力强
STRONG CARRYING CAPACITY

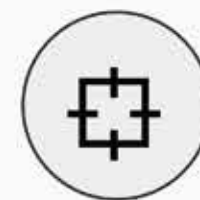

精准控制
PRECISE CONTROL



便捷操作
EASY TO OPERATE

EPS-RH系列产品命名规则
EPS-RH SERIES NAMING CONVENTIONS

DIVERSIFIED APPLICATION SCENARIOS
多元化适用场景

EPS-RH-17-100-C-B-S
① ② ③ ④ ⑤ ⑥ ⑦

- ① 品牌名称: EPS
Brand Name E-Efficiency P-Precision S-Smart
- ② RH代表系列名: 一体化谐波模组
RH Stands For The Series Name: Integrated Harmonic Actuator
- ③ 谐波型号 例如: 14/17/20/25/32等
Harmonic Model e.g: 14/17/20/25/32 etc
- ④ 减速比 1:100
Reduction ratio 1:100
- ⑤ 通信方式 C: CAN BUS
Communication C: CAN BUS
- ⑥ N: 不抱闸 B: 抱闸
N: Without Brake B: with Brake
- ⑦ S: 单编码器 D: 双编码器
S: Single encoder D: Dual encoder

例如 For example

型号 EPS-RH-20-100-C-N-S

说明 EPS: 品牌名
RH: 中空谐波模组
20: 谐波型号
100: 谐波减速比100:1
C: CAN bus 通信
N: 不抱闸
S: 单编码器

Model EPS-RH-20-100-C-N-S

Illustrate EPS: Brand Name
RH: Hollow harmonic module
20: Harmonic model
100: Harmonic gear ratio 100:1
C: Communication C: CAN BUS
N: Without Brake
S: Single Encoder



机械臂
Robotic Arm



食品加工设备
Food Processing



医疗器械
Medical Equipment



数控铣床
CNC Bed



造船工业
Shipbuilding Industry



航空工业
Aviation Industry

系列名 Series Name

EPS-RH

电机简称 Motor Simplified Name

RH-14



单编码器 Single Encoder + CAN BUS

离轴编码器 Off Axis Encoder

型号 Actuator Full Name	抱闸/非抱闸 With Brake/Without Brake	编码器 Encoder
EPS-RH-14-100-C-N-S	N (without brake)	Single Encoder

- * 1. 标准品电机可支持抱闸或不抱闸。The standard motor can support both brake or without brake.
- * 2. 标准品电机没有防水功能，如需IP54请订单前联系销售。The standard motor no IP protection. If need IP54 please contact salesman before order.
- * 3. 标准品电机只支持CAN BUS。The standard motor only support CAN BUS communication.

尺寸安装图 Installation Drawing

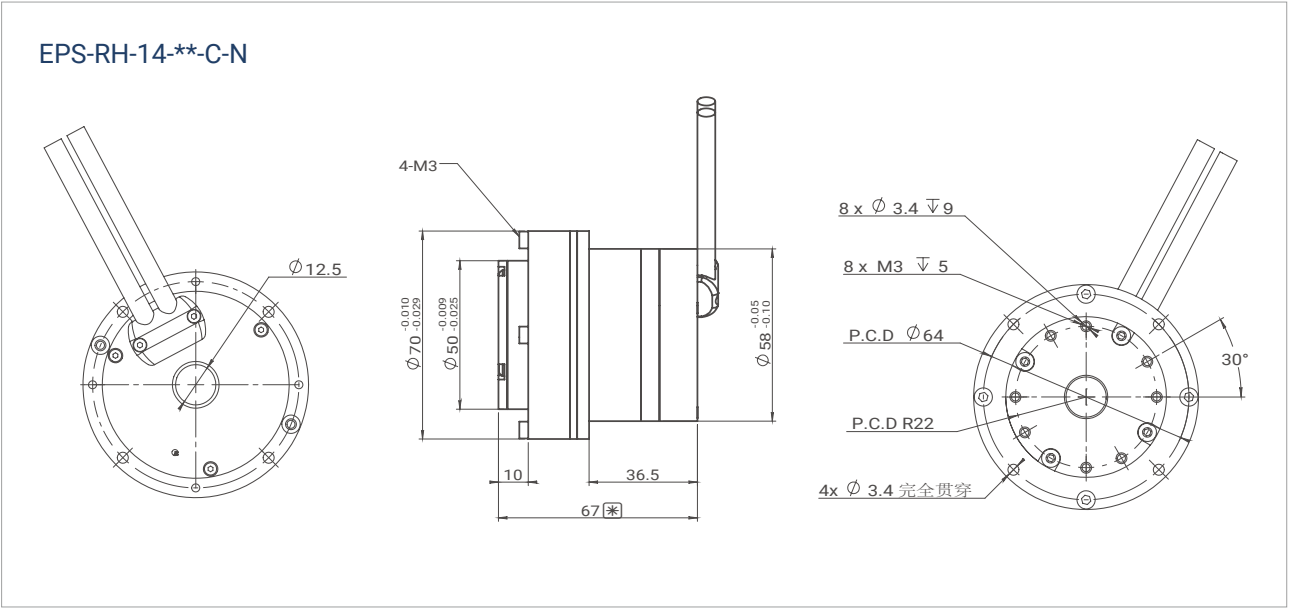

产品参数 Product Parameters

参数 Parameters	单位 Unit	RH-14
减速比 Gear ratio	—	100
输入电压 Input Voltage	V	48
空载转速 No Load Speed	RPM	30
空载电流 No Load Current	A	0.9
额定转速 Rated Speed	RPM	25
额定转矩 Rated Torque	N.m	11
额定功率 Rated Power	W	100
额定电流 Rated Current	A	6.5
峰值扭矩 Peak Torque	N.m	28
峰值电流 Peak Current	A	16.25
反电势常数 Back-EMF Constant	Vdc/Krpm	1.39
扭矩常数 Torque Constant	N.m/A	0.02
线电阻 Phase Resistance	Ω	0.9
线电感 Phase Inductance	mH	0.4
极对数 Pole Pair	—	10
接线方式 3 Phase Connection	—	Y
背隙 Backlash	Arcsec	< 20
编码器类型及接口 Encoder Type&Interface	—	ABS-17bit
重复定位精度 Repeat Position Accuracy	Degree	< 0.01
通信方式 Communication	—	CAN BUS
重量 Weight (N)	Kg	0.71
重量 Weight (B)	Kg	/
绝缘等级 Insulation grade	—	F

* **额定扭矩测试方法：**在环境温度摄氏24度（无其他散热方式）下，在额定转速下进行测试，电机扭矩在温升60度条件下达到温度平衡、可长时间工作点为该电机额定扭矩值。

* **Rated torque test method:** When the ambient temperature is 24 degrees Celsius (no other heat dissipation methods), the test is performed at the rated speed. The motor torque reaches temperature balance under the condition of a temperature rise of 60 degrees Celsius, and the long-term working point is the rated torque value of the motor.

系列名 Series Name

EPS-RH

电机简称 Motor Simplified Name

RH-17

单编码器 Single Encoder + CAN BUS

离轴编码器 Off Axis Encoder

型号 Actuator Full Name	抱闸/非抱闸 With Brake/Without Brake	编码器 Encoder
EPS-RH-17-100-C-N-S	N (without brake)	Single Encoder
EPS-RH-17-100-C-B-S	B (with brake)	Single Encoder

* 1. 标准品电机可支持抱闸或不抱闸。The standard motor can support both brake or without brake.

* 2. 标准品电机没有防水功能，如需IP54请订单前联系销售。The standard motor no IP protection. If need IP54 please contact salesman before order.

* 3. 标准品电机只支持CAN BUS。The standard motor only support CAN BUS communication.

尺寸安装图 Installation Drawing

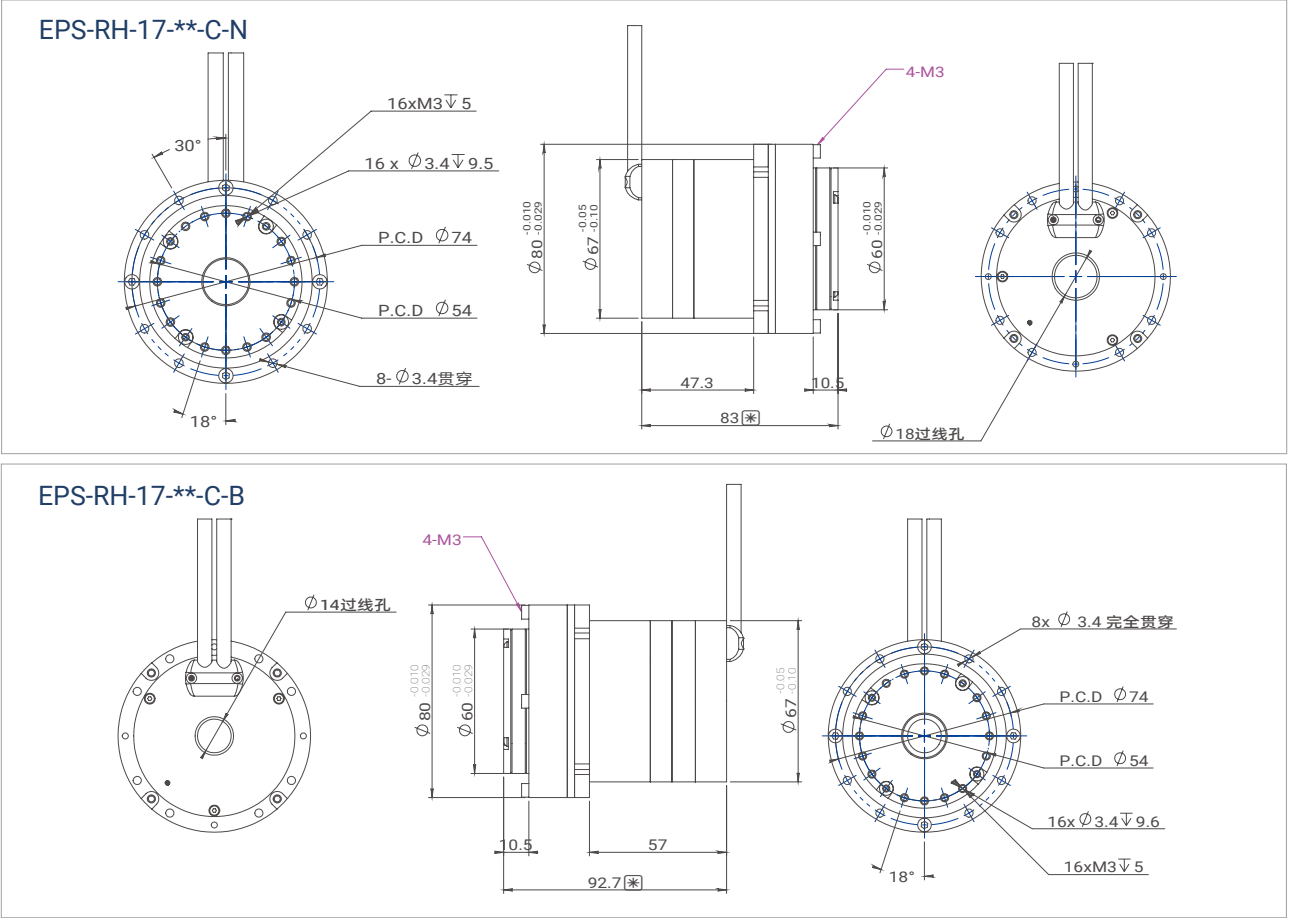

产品参数 Product Parameters

参数 Parameters	单位 Unit	RH-17
减速比 Gear ratio	—	100
输入电压 Input Voltage	V	48
空载转速 No Load Speed	RPM	30
空载电流 No Load Current	A	1.45
额定转速 Rated Speed	RPM	25
额定转矩 Rated Torque	N.m	35
额定功率 Rated Power	W	180
额定电流 Rated Current	A	9
峰值扭矩 Peak Torque	N.m	54
峰值电流 Peak Current	A	13.86
反电势常数 Back-EMF Constant	Vdc/Krpm	2.79
扭矩常数 Torque Constant	N.m/A	0.04
线电阻 Phase Resistance	Ω	0.77
线电感 Phase Inductance	mH	0.38
极对数 Pole Pair	—	10
接线方式 3 Phase Connection	—	Y
背隙 Backlash	Arcsec	< 20
编码器类型及接口 Encoder Type&Interface	—	ABS-17bit
重复定位精度 Repeat Position Accuracy	Degree	< 0.01
通信方式 Communication	—	CAN BUS
重量 Weight (N)	Kg	1.1
重量 Weight (B)	Kg	1.25
绝缘等级 Insulation grade	—	F

* 额定扭矩测试方法：在环境温度摄氏24度（无其他散热方式）下，在额定转速下进行测试，电机扭矩在温升60度条件下达到温度平衡、可长时间工作点为该电机额定扭矩值。

* Rated torque test method: When the ambient temperature is 24 degrees Celsius (no other heat dissipation methods), the test is performed at the rated speed. The motor torque reaches temperature balance under the condition of a temperature rise of 60 degrees Celsius, and the long-term working point is the rated torque value of the motor.

系列名 Series Name

EPS-RH

电机简称 Motor Simplified Name

RH-20



单编码器 Single Encoder + CAN BUS

离轴编码器 Off Axis Encoder

型号 Actuator Full Name	抱闸/非抱闸 With Brake/Without Brake	编码器 Encoder
EPS-RH-20-100-C-N-S	N (without brake)	Single Encoder
EPS-RH-20-100-C-B-S	B (with brake)	Single Encoder

* 1. 标准品电机可支持抱闸或不抱闸。The standard motor can support both brake or without brake.

* 2. 标准品电机没有防水功能，如需IP54请订单前联系销售。The standard motor no IP protection. If need IP54 please contact salesman before order.

* 3. 标准品电机只支持CAN BUS。The standard motor only support CAN BUS communication.

尺寸安装图 Installation Drawing

EPS-RH-20-**-C-N

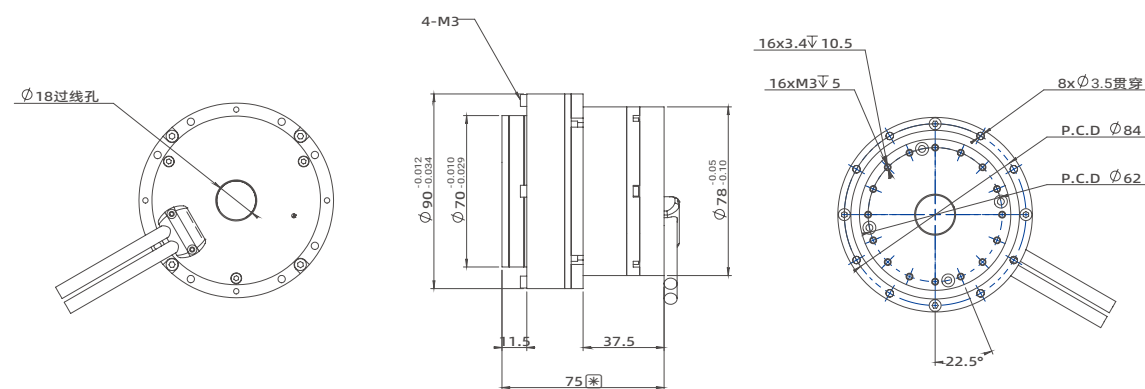

EPS-RH-20-**-C-B

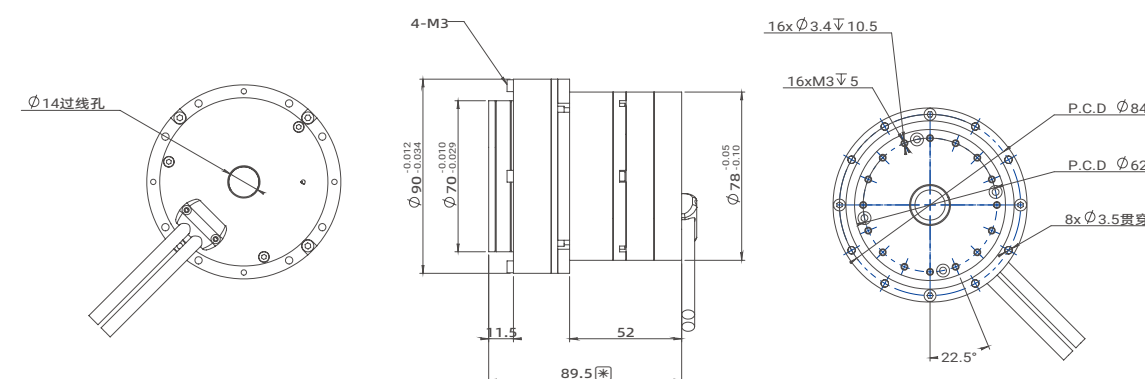

产品参数 Product Parameters

参数 Parameters	单位 Unit	RH-20
减速比 Gear ratio	—	100
输入电压 Input Voltage	V	48
空载转速 No Load Speed	RPM	30
空载电流 No Load Current	A	2.59
额定转速 Rated Speed	RPM	25
额定转矩 Rated Torque	N.m	50
额定功率 Rated Power	W	250
额定电流 Rated Current	A	13
峰值扭矩 Peak Torque	N.m	80
峰值电流 Peak Current	A	20.8
反电势常数 Back-EMF Constant	Vdc/Krpm	2.79
扭矩常数 Torque Constant	N.m/A	0.04
线电阻 Phase Resistance	Ω	0.38
线电感 Phase Inductance	mH	0.33
极对数 Pole Pair	—	10
接线方式 3 Phase Connection	—	Y
背隙 Backlash	Arcsec	< 20
编码器类型及接口 Encoder Type&Interface	—	ABS-17bit
重复定位精度 Repeat Position Accuracy	Degree	< 0.01
通信方式 Communication	—	CAN BUS
重量 Weight (N)	Kg	1.45
重量 Weight (B)	Kg	1.6
绝缘等级 Insulation grade	—	F

* 额定扭矩测试方法: 在环境温度摄氏24度(无其他散热方式)下, 在额定转速下进行测试, 电机扭矩在温升60度条件下达到温度平衡、可长时间工作点为该电机额定扭矩值。

* **Rated torque test method:** When the ambient temperature is 24 degrees Celsius (no other heat dissipation methods), the test is performed at the rated speed. The motor torque reaches temperature balance under the condition of a temperature rise of 60 degrees Celsius, and the long-term working point is the rated torque value of the motor.

系列名 Series Name

EPS-RH

电机简称 Motor Simplified Name

RH-25

单编码器 Single Encoder + CAN BUS

离轴编码器 Off Axis Encoder

型号 Actuator Full Name	抱闸/非抱闸 With Brake/Without Brake	编码器 Encoder
EPS-RH-25-100-C-N-S	N (without brake)	Single Encoder
EPS-RH-25-100-C-B-S	B (with brake)	Single Encoder

* 1. 标准品电机可支持抱闸或不抱闸。The standard motor can support both brake or without brake.

* 2. 标准品电机没有防水功能，如需IP54请订单前联系销售。The standard motor no IP protection. If need IP54 please contact salesman before order.

* 3. 标准品电机只支持CAN BUS。The standard motor only support CAN BUS communication.

尺寸安装图 Installation Drawing

EPS-RH-25-**-C-N

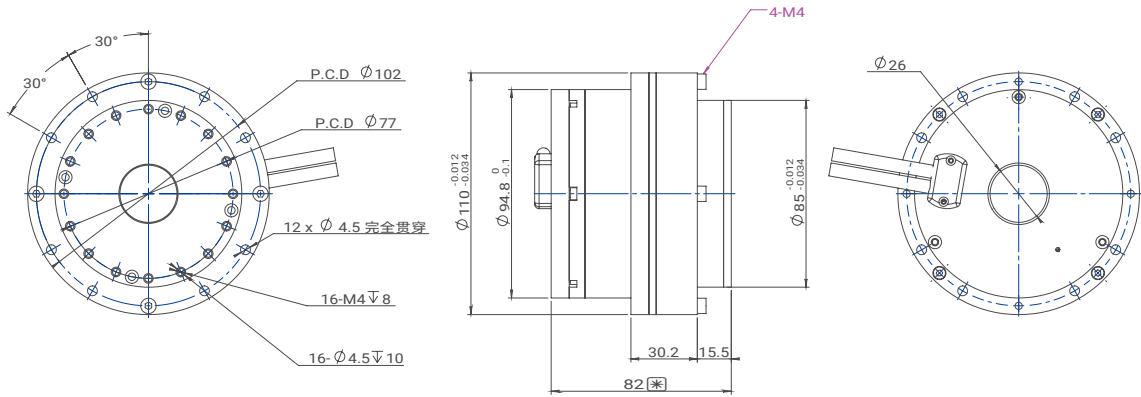

EPS-RH-25-**-C-B

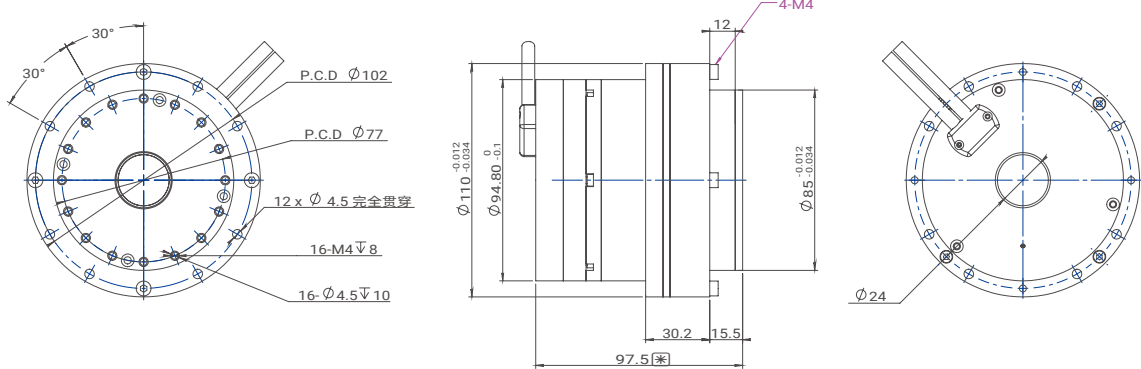

产品参数 Product Parameters

参数 Parameters	单位 Unit	RH-25
减速比 Gear ratio	—	100
输入电压 Input Voltage	V	48
空载转速 No Load Speed	RPM	30
空载电流 No Load Current	A	1.61
额定转速 Rated Speed	RPM	25
额定转矩 Rated Torque	N.m	108
额定功率 Rated Power	W	400
额定电流 Rated Current	A	16
峰值扭矩 Peak Torque	N.m	157
峰值电流 Peak Current	A	23.2
反电势常数 Back-EMF Constant	Vdc/Krpm	4.89
扭矩常数 Torque Constant	N.m/A	0.07
线电阻 Phase Resistance	Ω	0.23
线电感 Phase Inductance	mH	0.3
极对数 Pole Pair	—	10
接线方式 3 Phase Connection	—	Y
背隙 Backlash	Arcsec	< 20
编码器类型及接口 Encoder Type&Interface	—	ABS-17bit
重复定位精度 Repeat Position Accuracy	Degree	< 0.01
通信方式 Communication	—	CAN BUS
重量 Weight (N)	Kg	2.3
重量 Weight (B)	Kg	2.82
绝缘等级 Insulation grade	—	F

* 额定扭矩测试方法：在环境温度摄氏24度（无其他散热方式）下，在额定转速下进行测试，电机扭矩在温升60度条件下达到温度平衡、可长时间工作点为该电机额定扭矩值。

* Rated torque test method: When the ambient temperature is 24 degrees Celsius (no other heat dissipation methods), the test is performed at the rated speed. The motor torque reaches temperature balance under the condition of a temperature rise of 60 degrees Celsius, and the long-term working point is the rated torque value of the motor.

系列名 Series Name

EPS-RH

电机简称 Motor Simplified Name

RH-32

单编码器 Single Encoder + CAN BUS

离轴编码器 Off Axis Encoder

型号 Actuator Full Name	抱闸/非抱闸 With Brake/Without Brake	编码器 Encoder
EPS-RH-32-100-C-N-S	N (without brake)	Single Encoder
EPS-RH-32-100-C-B-S	B (with brake)	Single Encoder

* 1. 标准品电机可支持抱闸或不抱闸。The standard motor can support both brake or without brake.

* 2. 标准品电机没有防水功能，如需IP54请订单前联系销售。The standard motor no IP protection. If need IP54 please contact salesman before order.

* 3. 标准品电机只支持CAN BUS。The standard motor only support CAN BUS communication.

尺寸安装图 Installation Drawing

EPS-RH-32-**-C-N

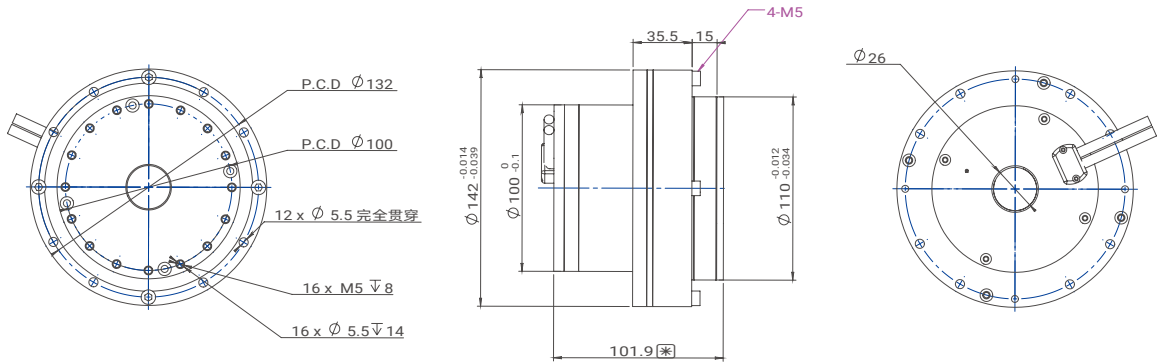

EPS-RH-32-**-C-B

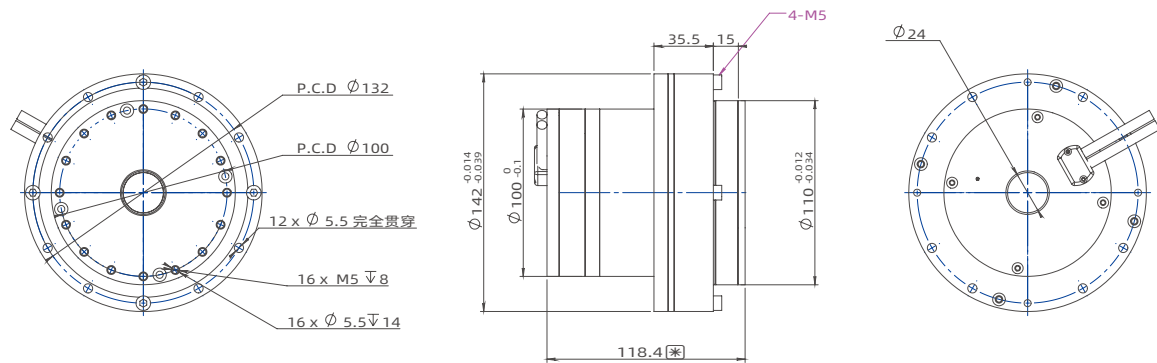

产品参数 Product Parameters

参数 Parameters	单位 Unit	RH-32
减速比 Gear ratio	—	100
输入电压 Input Voltage	V	48
空载转速 No Load Speed	RPM	20
空载电流 No Load Current	A	3.9
额定转速 Rated Speed	RPM	18
额定转矩 Rated Torque	N.m	150
额定功率 Rated Power	W	700
额定电流 Rated Current	A	20
峰值扭矩 Peak Torque	N.m	229
峰值电流 Peak Current	A	33.44
反电势常数 Back-EMF Constant	Vdc/Krpm	6.28
扭矩常数 Torque Constant	N.m/A	0.09
线电阻 Phase Resistance	Ω	0.08
线电感 Phase Inductance	mH	0.13
极对数 Pole Pair	—	10
接线方式 3 Phase Connection	—	Y
背隙 Backlash	Arcsec	< 20
编码器类型及接口 Encoder Type&Interface	—	ABS-17bit
重复定位精度 Repeat Position Accuracy	Degree	< 0.01
通信方式 Communication	—	CAN BUS
重量 Weight (N)	Kg	4.3
重量 Weight (B)	Kg	4.7
绝缘等级 Insulation grade	—	F

* 额定扭矩测试方法：在环境温度摄氏24度（无其他散热方式）下，在额定转速下进行测试，电机扭矩在温升60度条件下达到温度平衡、可长时间工作点为该电机额定扭矩值。

* Rated torque test method: When the ambient temperature is 24 degrees Celsius (no other heat dissipation methods), the test is performed at the rated speed. The motor torque reaches temperature balance under the condition of a temperature rise of 60 degrees Celsius, and the long-term working point is the rated torque value of the motor.